

LEGEND

- - 5/8" DIA. x 30" REBAR SET WITH PLASTIC CAP STAMPED "RICHLAND ENG. RLS 7209"
- ◆ - RAILROAD SPIKE SET
- - SURVEY MARKER FOUND WITH CAP STAMPED "RICHLAND ENGINEERING LIMITED, ROBERT A. CUNNING, RLS 4939"
- - IRON PIN FOUND
- ⊕ - RAILROAD SPIKE FOUND
- ⊕ - UTILITY MARKER POST
- ⊕ - POWER POLE
- ⊕ - POWER AND LIGHT POLE
- ⊕ - UNDERGROUND TELEPHONE
- ⊕ - GAS MAIN VALVE AND GAS LINE

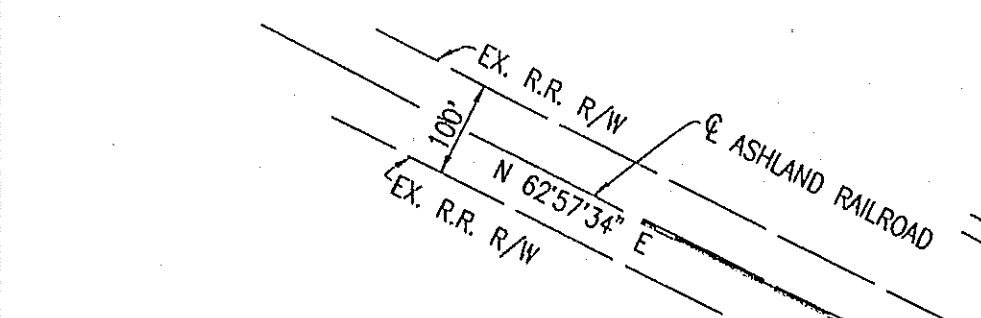

CENTERLINE RAILROAD CURVE DATA

C1	C2
Δ = 726°00'	Δ = 341°13'00"
R = 4583.75'	R = 2292.01'
Dc = 1°15'00"	Dc = 2°30'00"
A = 594.66'	A = 1372.11'
T = 297.76'	T = 707.30'
E = 9.66'	E = 106.65'

CENTERLINE OF PROPOSED RAILROAD SPUR CURVE DATA

C4	C5	C6
Δ = 28°00'33"	Δ = 1°02'50"	Δ = 7°40'35"
R = 573.69'	R = 716.78'	R = 716.78'
A = 280.45'	A = 13.10'	A = 96.03'
Dc CHORD = 10°00'00"	Dc CHORD = 8°00'00"	Dc CHORD = 8°00'00"
CHD. BRG. = N 77°19'38" W	CHD. BRG. = N 63°50'47" W	CHD. BRG. = N 68°12'30" W
CHORD = 277.66'	CHORD = 13.10'	CHORD = 95.96'

BASIS OF BEARING IS THE EAST LINE OF THE NORTHEAST QUARTER OF SECTION 9 BEING SOUTH 00°36'15" EAST AS CALLED FOR IN PLAT BOOK VOLUME 26 PAGE 114.

O.D.O.T. REFERENCE USED

- RIC - S.H.87 - SEC. A (1933) SHEET 4-8
- RIC - 13-17.03 R.O.W. SHEETS 1-3
- RIC - 13-17.48 R.O.W. SHEETS 1-2
- RIC I.C.H. 287 SEC. A R.O.W. MONUMENT REPORT

A TITLE SEARCH WAS NOT PERFORMED. THERE MAY BE EASEMENTS AFFECTING THE SUBJECT PARCEL THAT DO NOT APPEAR ON THIS DRAWING.

3/4" IP FND. N.W. CORNER N.E. 1/4 SEC. 9

PARAGON PARKWAY PLAT VOLUME 26 PAGE 114

OHIO FUEL GAS LEASE, LEASE RECORD 45 PAGE 171.

EASEMENT FOR PIPELINES TO COLUMBIA GAS OF OHIO D.V. 587 P.96

EASEMENT FOR SEWER LINES TO CITY OF MANSFIELD. D.V. 697 P.136

ARMCO INC. O.R.V. 155 P. 242 P.P. No. 028-90-036-17-000

94.312 ACRES IN THE NORTHEAST QUARTER 22.013 ACRES IN THE SOUTHEAST QUARTER 116.325 TOTAL ACRES

P.P. No. 028-90-037-03-000

AUTHORIZATION TO RELOCATED POLE LINE FROM STATE OF OHIO TO AT & T D.V. 441 P.239 * THERE ARE NO LONGER POLES ON SITE.

EASEMENT FOR ELECTRIC TRANSMISSION LINES TO OHIO EDISON CO. D.V. 701 P.865

C7
Δ = 28°00'33"
R = 603.69'
A = 295.11'
T = 150.57'
E = 18.49'
Dc CHORD = 9°30'07"
CHD. BRG. = N 77°19'38" W
CHORD = 292.18'

APPROXIMATE 100 YEAR FLOOD PLAIN AS SHOWN ON F.E.M.A. COMMUNITY-PANEL NUMBER 390477 0010 C EFFECTIVE DATE JANUARY 3, 1986

P.P. No. 028-90-037-02-000

EASEMENT FOR PIPELINE TO COLUMBIA GAS OF OHIO D.V. 711 P.150

APPROVED BY THE MANSFIELD CITY PLANNING COMMISSION. NO PLAT REQUIRED.

SIGNED: *Robert J. McAuley*
SECRETARY, CITY PLANNING COMMISSION.
DATE: 4-23-97

"The grantor, grantee and all subsequent owners or assignees taking title from, under or through the grantor or grantee agrees that any use or improvement made on this land shall be in conformity with all existing valid zoning, platting, health, or other local rules and regulations."

Robert J. McAuley
ROBERT J. McAULEY
RLS 7209

April 11, 1997
DATE

NEW SPILT TAX MAP ATTACHED
EAS 493971

CENTERLINE S.R. 13 CURVE DATA

C3
Δ = 41°10'00"
R = 2894.13'
Dc = 1°58'47"
A = 2079.42'
T = 1086.87'
E = 197.35'

Δ = 9°43'25"
R = 2969.13'
Dc = 1°55'47"
A = 503.89'
T = 252.55'
E = 10.72'

DETAIL OF WEST RIGHT OF WAY LINE OF STATE ROUTE 13

NOT TO SCALE

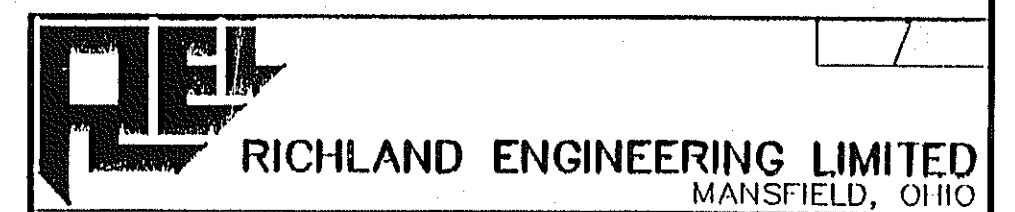

SURVEY FOR THE CITY OF MANSFIELD

SITUATED IN THE CITY OF MANSFIELD AND BEING A PART OF THE NORTHEAST AND SOUTHEAST QUARTERS OF SECTION 9, TOWNSHIP 21, RANGE 18, RICHLAND COUNTY, STATE OF OHIO

DESIGNED	DRAWN	TRACED	CHECKED	REVIEWED	DATE	REVISE

97012-1.DWG Job No. 97012 Date 4/11/97 Drawn By RMC/KH