

PENNSYLVANIA R.R. E

394.5

E 1/4 SEC 27 TWP 21

R.R. R/W LINE
S 51°-00'E

1027.89

135.7

BUCHAN PROPERTY
VOL. 409 PA. 678 E 475

2.14 Ac[±]

S 51° 00' E 451.80

1.18 Ac[±]

434.79' N 51° 00' W

576° 16' E 534.25
108.59
145.89
N 76° 16' W

101.42
584° 00' W
125.00
N 84° 00' E

300.65
100.00
N 33° 00' E

22.12 Ac[±]

746.53

S 38° 33' W

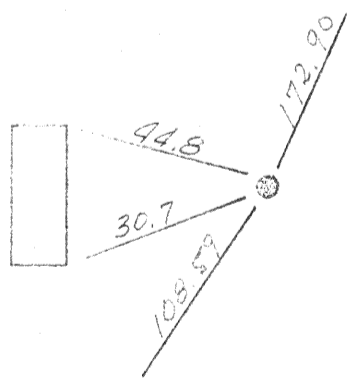

N 14° 03' W
272.72

N 24° 25' W
99.10

OAK ST.
N 35° 34' W

593.81

135.15
N 39° 01' W

188.30
N 45° 05' W

307.62
N 52° 16' W

292.34
N 50° 59' W

BY *James B. Roberts*
JAMES B. ROBERTS
REG. SURVEYOR # 4279

PLAT OF SURVEY
HERRING PROPERTY
Part of N.E. 1/4 SEC. 27 TWP 21
RA. 18 MADISON TWP RICHLAND CO.
4-9-70, 4-22-70, 5-13-77

TITLE		SCALE	DRAWN BY
DATE		APPROVED BY	
DRAWING NUMBER			