

ACRES:
 In SE 1/4 : 2.846 Ac.
 In SW 1/4 : 31.470 Ac.
 In NW 1/4 : 1.665 Ac.
 In NE 1/4 : 84.320 Ac.
 Total : 120.301 Ac.

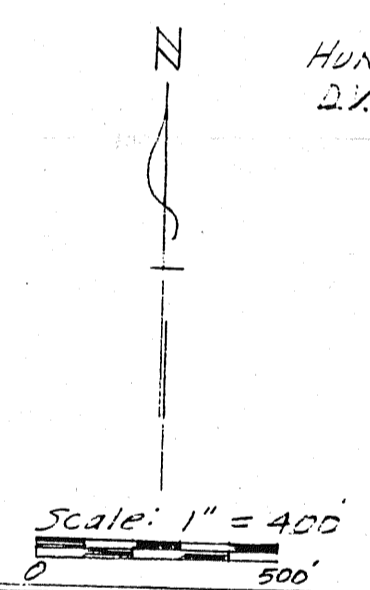

- = Iron Pin, found
- = Iron Pin, set & capped "LITTLE - 5524"
- ▲ = P.K. Nail, set
- ▼ = RR Spike, found

SURVEY FOR THOS. RINGLER
 PART OF NE, SE, SW & NW QUARTERS
 OF SEC. 23, TWP. 23, RING 18, IN WELLES
 TWP. COUNTY OF RICHLAND, STATE OF OHIO
 Robert M. Little
 Reg. Prof. Surveyor # Ohio 5524
 May 31, 1993

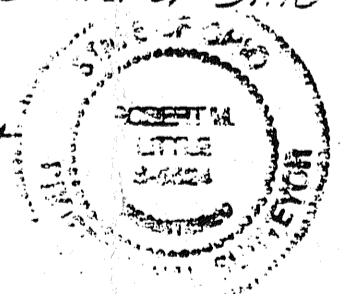

TO BEST OF MY KNOWLEDGE THIS
 CONFORMS TO WELLES TWP
 ZONING RESOLUTIONS OF THIS DATE
 6-3-93 *Lawrence*
 BLDG + ZONING INST.
 WELLES TWP.

APPROVED BY THE MANSFIELD CITY PLANNING COMMISSION;
 NO PLAT REQUIRED.
 SIGNED: *[Signature]*
 SECRETARY, CITY PLANNING COMMISSION;
 DATE: 6-8-93

The grantor, grantee and all subsequent owners
 or assignees taking title from, under or through
 the grantor or grantee agrees that any use or
 improvement made on this land shall be in
 conformity with all existing valid zoning, platting,
 health, or other lawful rules and regulations.

NEW SPLIT
 TAX MAP APPROVED
 LSK 6 8 93
 INITIAL DATE